

TONNEAU COVER FITTING INSTRUCTION

TOYOTA HILUX SR5 A DECK EXTRA CAB WITH SPORT BAR

October 2015 – Current

Part No: ATC01342

BASIC TOOLS REQUIRED

Drill, 4mm Drill Bits, Rivet Gun, Marking Pencil/ Pen

CONTENTS

- | | |
|----------------------------|---------------------|
| - 1 x Tonneau Cover | - 4 x Bar Brackets |
| - 2 x Tonneau Support Bars | - 26 x Rivets |
| - 1 x Aluminium Tailgate | - 5 x Rope Hooks |
| - 2 x Rear Side Aluminium | - 2 x Washers |
| - 2 x Front Side Aluminium | - 1 x Metal Bracket |

1. INSTALLATION PROCEDURE

1. Attach the Front side aluminium rails (380mm Long) Centre the rail between the sports bars.
2. Ensure the aluminium is square with the top of the tub and the notch must be at the front. *See Figure 1*
3. Measure and mark a spot 50mm in from each end and 30mm up from the bottom edge of the rail.
4. Drill through these locations into the tub using a 4.5mm drill bit. Then rivet into place. *See Figure 2*
5. Attach the Rear side Aluminium Rails (970mm Long), position the rail behind the sports bars. Ensure the aluminium is square with the top of the tub.

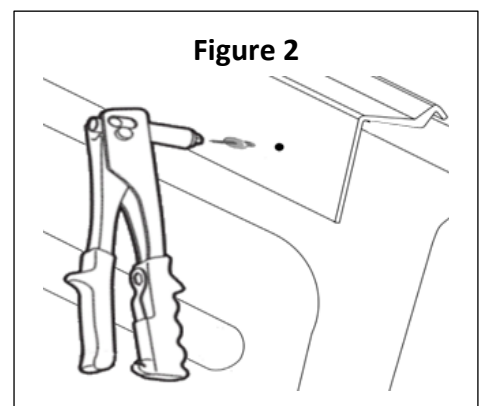
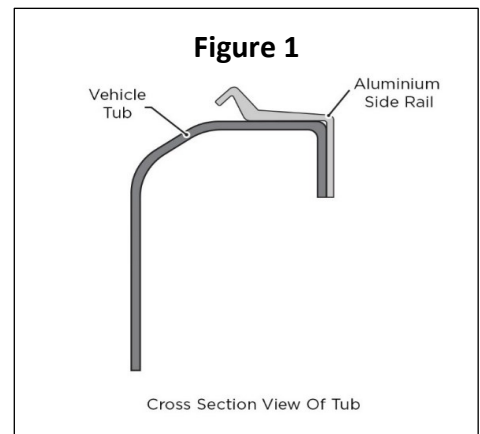

6. From the front edge of the rail, 30mm from the bottom edge, measure and mark the following locations:
- 15mm, 47mm, 255mm, 465mm, 497mm, 708mm and 920mm.

Figure 3

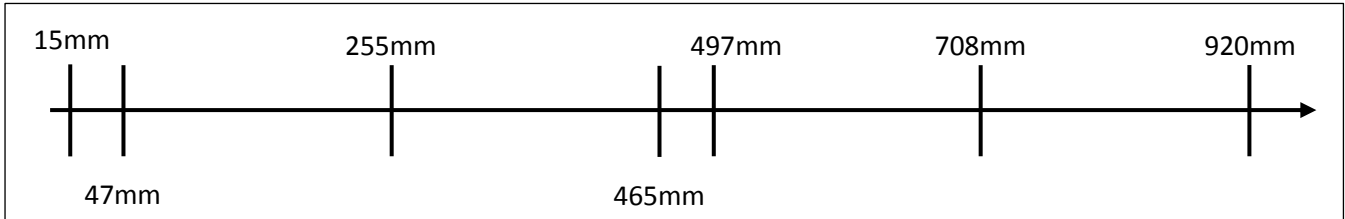

7. Drill through these locations into the tub using a 4.5mm drill bit. Position rail directly behind the sport bar, 5mm gap from rear sport bar. Ensure the aluminium is square with the top of the tub.
8. Utilising the rivets provided, use your rivet gun to rivet the rail at 255mm, 708mm and 920mm.

9. Attach the bar bracket by placing a 4mm rivet through each hole of the bracket and into the remaining holes (15mm, 47mm, 465mm and 497mm). *See Figure 4*

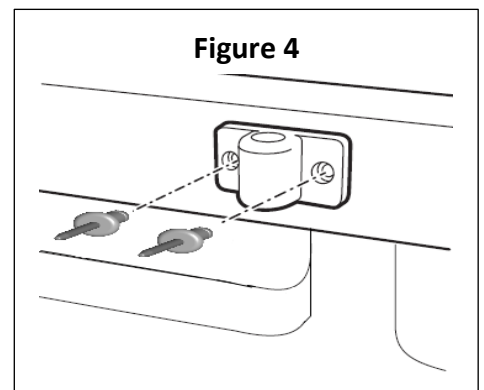

10. Repeat those steps for the other side.

11. Multi-fit support refer to section 2.

12. To attach the tailgate rail, measure and mark the centre of the tailgate and aluminium rail, 302mm and 605mm from the centre of the rail, 30mm from the edge of the rail. *See Figure 5*

Figure 5

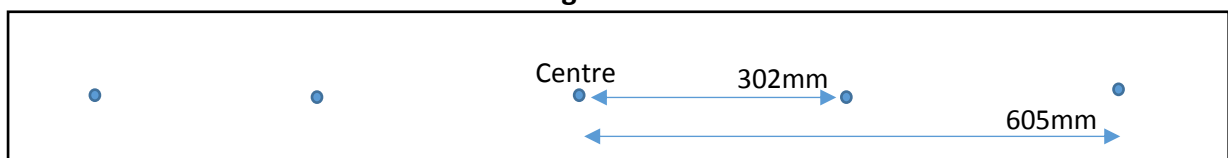

13. Position the aluminium in the centre of the tailgate, so that it is sitting square with the top surface of the tailgate.

14. Drill through each of the holes in the Aluminium rail into the tailgate. Rivet the tailgate rail to the tailgate to complete the attachment.

15. To attach the tonneau cover, fit the front of the Tonneau Cover to the front of the Ute tub placing the Plastic Retainer (Fitted on the Tonneau Cover) on to the Metal Lip on the Body, between the cabin and the Ute Body. (Behind rear windscreen). *See Figure 6*

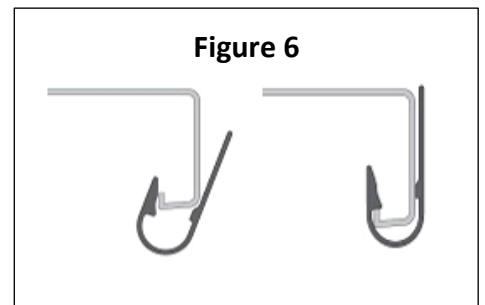

16. Clip the plastic onto the tailgate rail.

17. Clip the driver's side of the cover onto the driver's side rail then attach the passenger side of the cover.

18. To remove cover once fitted peel cover away from Aluminium clip in rail by peeling away from the edge of the plastic. *See Figure 7*

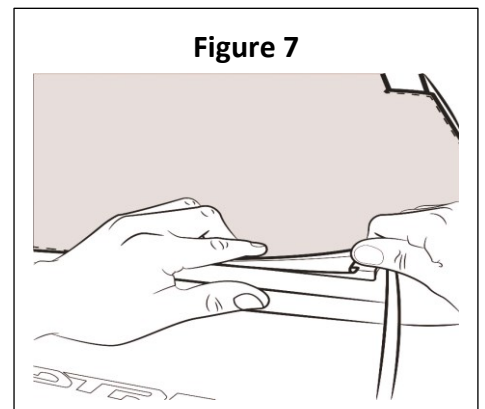

IMPORTANT: Do not use cover corners to lift. Always use plastic edges.

You can adjust your tonneau, to make it tighter or looser, by simply raising or lowering the height of your tonneau support bar.

2. MULTI-FIT SUPPORT BAR

The Aussie Tonneau Multi - Fit Support Bar is designed to fit almost all Utes on the Market, from Subaru Brumbys to Cab Chassis aluminium trays.

2.1 BASIC TOOL REQUIRED

- Drill, 4mm drill bit

2.2 MULTI-FIT SUPPORT BAR CONTENTS

- 1 x hollow bar centrepiece
- 2 x grub screws
- 2 x solid bar end piece

2.3 FITTING MULTI-FIT BAR

1. Insert solid bar pieces into either end of hollow tube. Adjust bar so it fits between bar bracket holders with the holes facing to the ground (so the grub screws don't rub against the tonneau), as shown above and then with a white pencil make a mark through the small holes of the hollow bar onto the solid ends. This is where you will drill a hole to the depth of about 1-2mm (do not go any further)
2. Join the pieces back together and screw grub screws through the hollow bar into the holes that you drilled. **Make sure you do not over tighten the grub screws.** Refit the bar. You may kink the bar in the middle to give it some extra height to assist with water runoff.

3. HOW TO FIT INTERNAL ELASTIC SHOCK CORD

- Tie a knot in one end of shock cord.
- Pull shock cord through all plastic hooks.
- Feed the shock cord through loops on the cover.
- Tie a knot at the other end
- Space the hooks as required
- Use washers to tie off rope

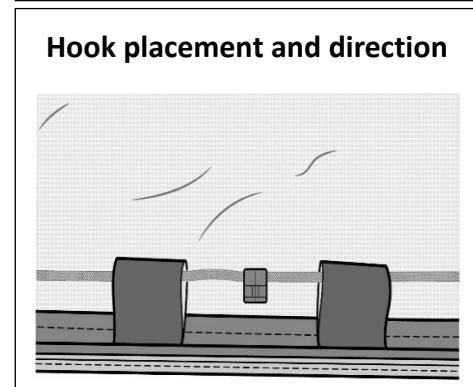
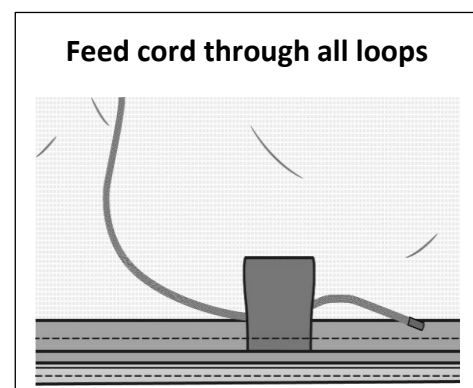
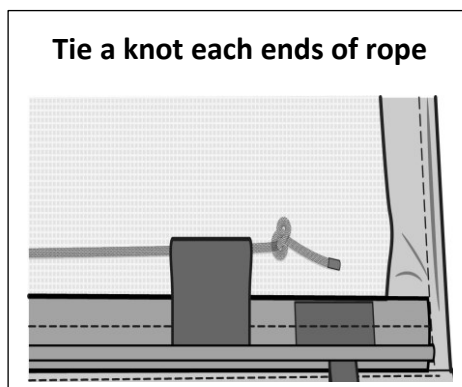

Using Internal Elastic Shock Cord:

The plastic clips on the internal shock cord can be hooked into the aluminium extrusions so that the cover can still be secured with larger loads in the tub.

Tonneau Cover Tethering System



- Rivet the extra Metal Bracket to the Front Driver Side Rail.
- Untie the end of the rope of the Cover and loop it through the Metal Bracket.
- Rethread the Washer and tie the end of the rope into a knot.

4. WARRANTY AND FEEDBACK

Register now to activate your 3 year warranty by filling out our online form!

QR Code:



Website Link:

<http://www.aussietonneaus.com.au/en-au/warranty-card-request-form.html>

Please complete our 2 minute feedback section as we strive to constantly improve for our customers.

Thank you for purchasing an Aussie Tonneaus Product.