

# TONNEAU INSTALLATION INSTRUCTION

## Mitsubishi MQ Triton Dual Cab With Sports Bar

July 2015 – Current

**Part number: ATC01251**

Package includes	
1 X Tonneau cover	2 x Bar Brackets
1 x Tonneau Support Bar	23 x Rivets
2 x Rear Side Rail (890mm)	1 x Fitting Instructions
1 x Front Side Rail (370mm)	2 x M8 Washers
1 x Tailgate Rail (1400mm)	

### **Please note before Fitment:**

- Read all instructions prior to fitting the Tonneau cover.
- Check that the fitting kit is complete before beginning the installation.
- If replacing a previously fitted Aussie Tonneaus Cover the front rope track must be removed from the vehicle.
- If replacing any other cover all hardware must be replaced with hardware supplied.

**Check the contents of the kit prior to fitment.**

# TONNEAU INSTALLATION INSTRUCTION

## Mitsubishi MQ Triton Dual Cab – With Sports Bar

### Step 1: Install the front Rail

- Temporarily loosen/remove the brackets attached the sport bars to the tub to install the front rail. Re-attach after Step 1.
- Place the front rail on the front top edge of the ute. The 50mm wall of the angle needs to be vertical. Align the vertical face of the angle with the inside edge of the tub (fig 2.)
- In line with the existing rivets in the front rail, drill 6 holes into the lower section of the aluminium and into the top edge of the tub. The first hole from each end to be about 50mm from the end of the angle. (Fig. 1).
- Apply silicone the bottom of the angle and pop rivet into place with 5 rivets. (Fig 2.)

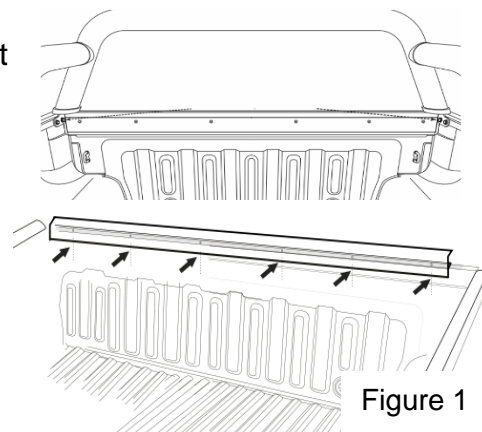

Figure 1

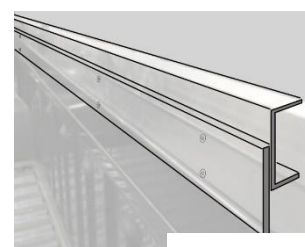

Figure 2

### Step 2: Attach Side Aluminium Rails

- Ensure the aluminium is square with the top of the tub. From the front edge of the rail, measure and mark the following locations:

Piece A – 130mm, 350mm

Piece B - 160mm, 193mm, 500mm, 800mm

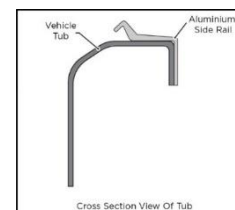

Cross Section View Of Tub

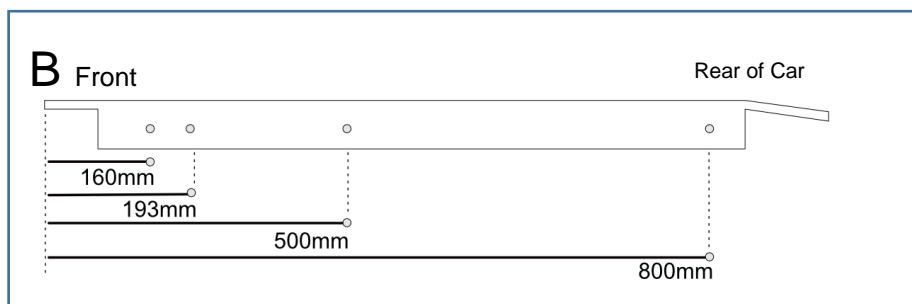
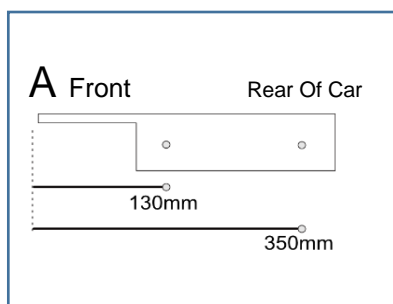

- Whilst on the car, drill through these locations and into tub, using 4.5 drill bit. **NOTE:** Repeat for both sides of car
- Attach the bar bracket by placing a 4mm rivet through each hole (160mm & 193mm) of the bracket and into the centre holes in the rail. (See Figure 3)
- Rivet the remaining holes attaching the aluminium rail to the side of the car's tub

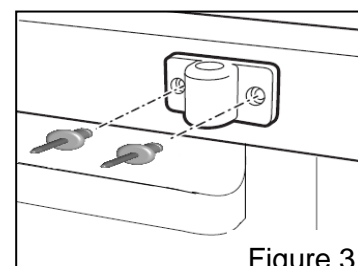
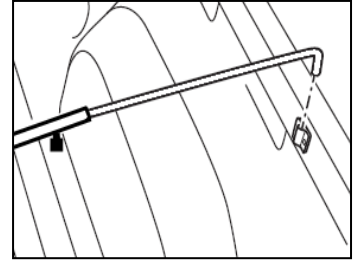

Figure 3

### Step 3: Fit Support Bar

- Insert support bar into bar brackets.



### Step 4: Attach Tailgate Rail

- Measure and mark the centre, and 25mm from either edge of the aluminium. Then mark
- Position the aluminium in the centre of the tailgate, so that it is sitting square with the top surface of the tailgate.

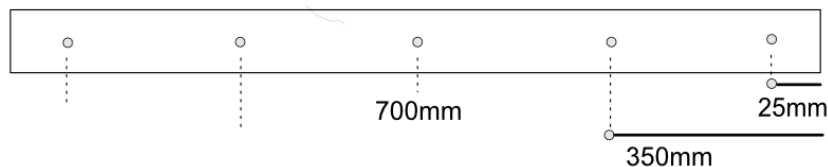
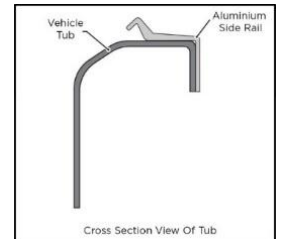

- Drill through each of the holes in the aluminium rail into the tailgate.
- Rivet the tailgate rail to the tailgate to complete the attachment.

### Step 5: Fit Cover

- Fit the front of the Tonneau Cover to the front of the Ute tub placing the Plastic Retainer (Fitted on the Tonneau Cover) on to the Metal Lip on the Body, between the cabin and the Ute Body. (Behind rear windscreen).
- Pull the cover under the sports bar and drape the cover across the tub.
- Clip the side plastics under the aluminium rails to stretch the cover.

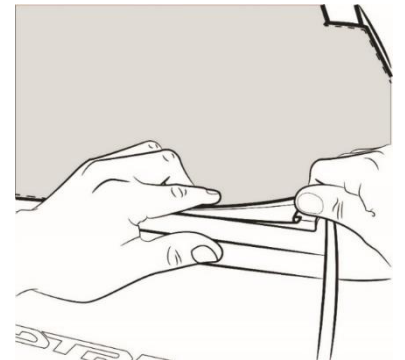

### Step 6: To Remove Cover Correctly

To remove cover once fitted peel cover away from aluminum clip in rail by peeling away from the edge of the plastic. You can adjust your tonneau, to make it tighter or looser, by simply raising or lowering the height of your tonneau support bar.

**IMPORTANT:** Do not use cover corners to lift, Always use plastic edges.

## How to Fit Internal Elastic Shock Cord

To be used for covering larger loads

- Tie a knot in one end of the shock cord.
- Pull shock cord through all plastic hooks.
- Feed the shock cord through loops on the cover.
- Tie a knot at the other end.
- Space the hooks as required.
- Use washers to tie off rope.

