

TONNEAU COVER FITTING INSTRUCTION

GREAT WALL V200 / V240

DUAL CAB WITH SPORT BAR

2009 – 2015

PART NO: ATB01340

BASIC TOOLS REQUIRED

Drill, 4mm Drill Bits, Rivet Gun, Marking Pencil/ Pen

CONTENTS

- 1 x Tonneau Cover
- 1 x Tonneau Support Bar
- 1 x Aluminium Ropetrack with Shim
- 1x Fitting Instruction
- 2 x Bar Brackets
- 34 x Rivets
- 16 x Rope Buttons
- 2 x Dowels
- 2 x 100mm Angle

1. INSTALLATION PROCEDURE

1. Position the 100mm angle just inside of the front corner, 5mm down. Drill two holes through angle into front wall of tray and rivet into place.
2. Place the 2 pieces of dowel in the ends of the rope track.
3. Rest the aluminium rope track on the side, and push forward to the vertical face of the tub. *See Figure 1*
4. Using a 4mm drill bit, drill a hole 15mm from each end of the aluminium rope track, 1 hole in the centre of the rope track and 1 hole each side in the middle of the centre.
5. Once all the holes have been drilled, remove the pieces of dowel. Squeeze silicon along the back of the rope tracks and pop rivet into place. *See Figure 2*

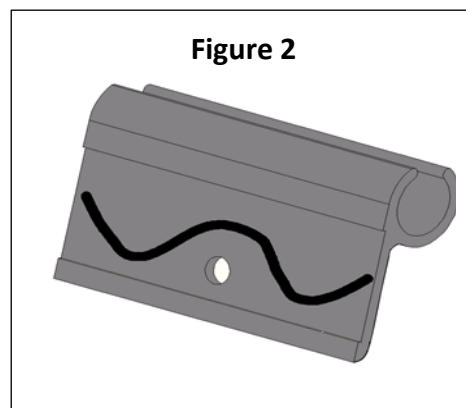
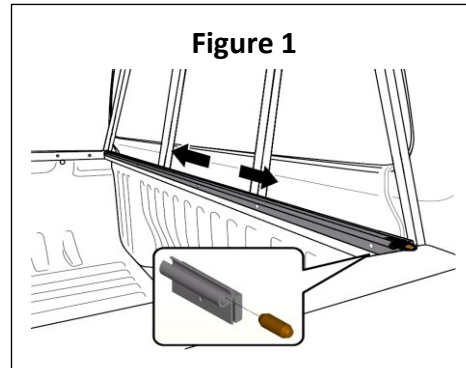

6. To fit bar brackets measure 695mm back from the inside front edge at the top of the tub (5mm down from top edge of tub).

See Figure 3

7. Drill and rivet using two large rivets for each Bar Bracket. Install support bar according to supplied instructions.

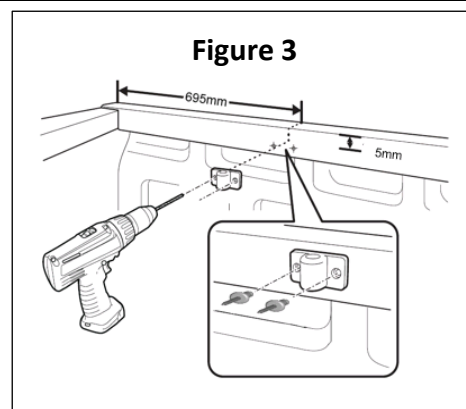

8. To fit round body hooks measure 175mm down from the inside edge and line up each hook individually to each bunji loop starting with the two either side of the tailgate handle and working your way around to the front, drill and rivet buttons alternating from side to side. **See Figure 4**

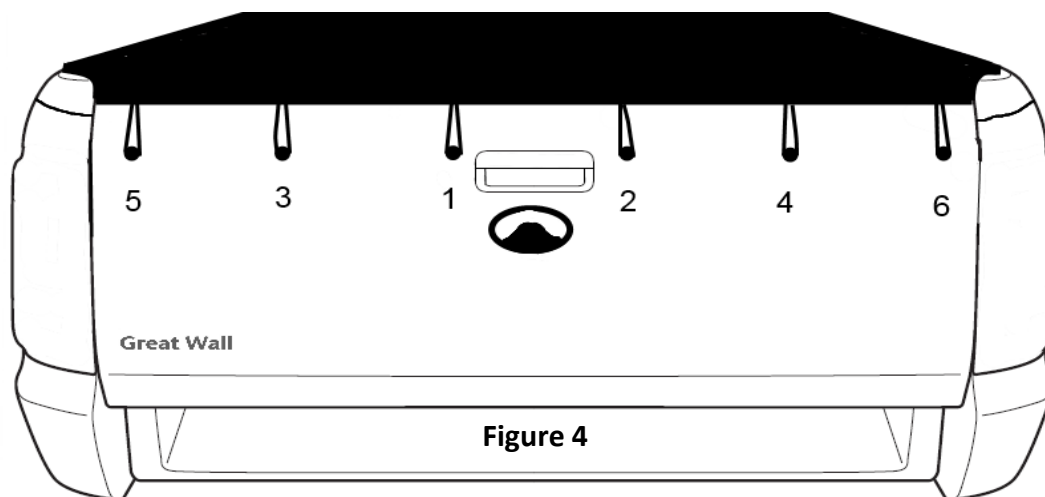

2. CARING FOR YOUR TONNEAU

Apply bee's wax or Dri-lube to stitching a few times a year, as this will maintain the tonneau's waterproofing ability and prevent the stitching from degrading. Use a mild detergent and soft scrubbing brush to clean tonneau.

Never drive without tonneau support bars in place as flapping can cause a delaminating effect on the material.

"Tonneau is not designed to be used as a load restraint"

3. MULTI-FIT SUPPORT BAR

The Aussie Tonneau Multi - Fit Support Bar is designed to fit almost all Utes on the Market, from Subaru Brumbys to Cab Chassis aluminium trays.

2.1 BASIC TOOL REQUIRED

- Drill, 4mm drill bit

2.2 MULTI-FIT SUPPORT BAR CONTENTS

- 1 x hollow bar centrepiece
- 2 x grub screws
- 2 x solid bar end piece

2.3 FITTING MULTI-FIT BAR

1. Insert solid bar pieces into either end of hollow tube. Adjust bar so it fits between bar bracket holders with the holes facing to the ground (so the grub screws don't rub against the tonneau), as shown above and then with a white pencil make a mark through the small holes of the hollow bar onto the solid ends. This is where you will drill a hole to the depth of about 1-2mm (do not go any further)
2. Join the pieces back together and screw grub screws through the hollow bar into the holes that you drilled. **Make sure you do not over tighten the grub screws.** Refit the bar. You may kink the bar in the middle to give it some extra height to assist with water runoff.

4. WARRANTY AND FEEDBACK

Register now to activate your 3 year warranty by filling out our online form!

QR Code:



Website Link:

<http://www.aussietonneaus.com.au/en-au/warranty-card-request-form.html>

Please complete our 2 minute feedback section as we strive to constantly improve for our customers.

Thank you for purchasing an Aussie Tonneaus Product.