

EZY FOLD FITTING INSTRUCTIONS

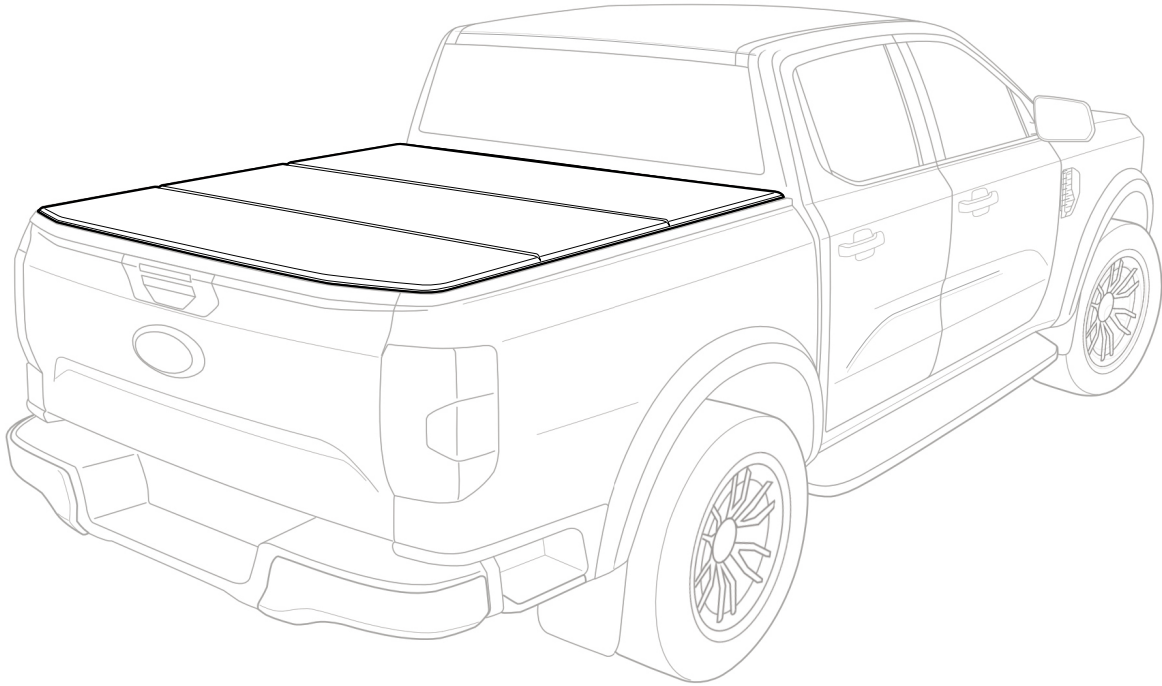

Parts In the Box

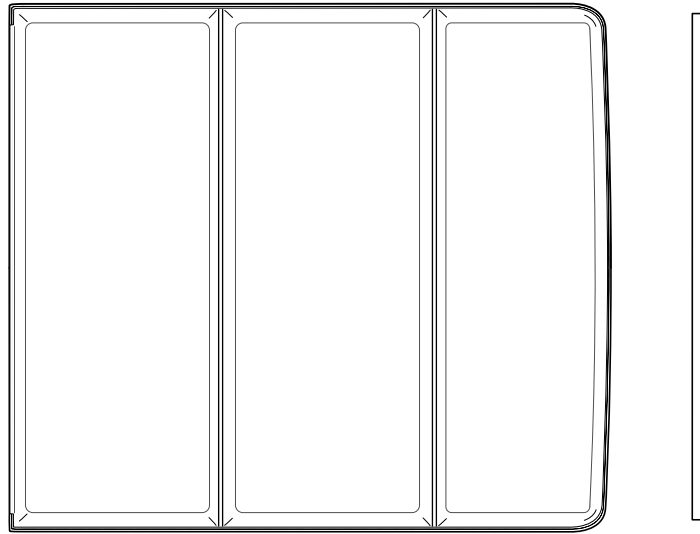
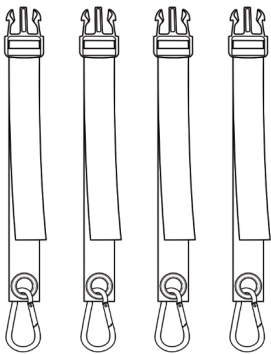

Hardware In the Box

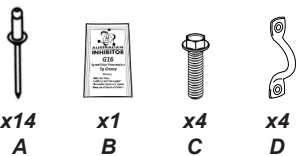

x14 A x1 B x4 C x4 D

Safety Notes

- Wear appropriate Personal Protective Equipment.
- During the accessory fitment, ensure all Australian automotive safety practices are followed.
- Always refer to the vehicles workshop manual when removing components.



Tools Required

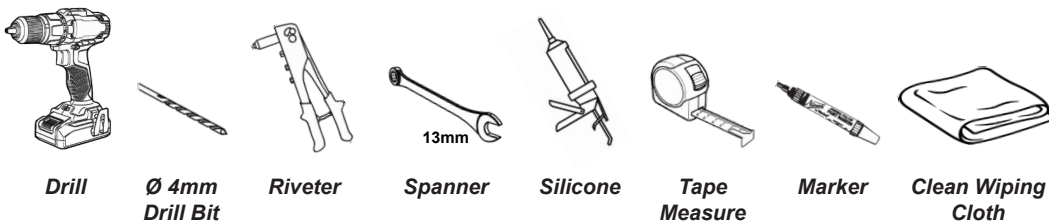

Drill Ø 4mm Drill Bit Riveter Spanner 13mm Silicone Tape Measure Marker Clean Wiping Cloth

Any vehicle accessories which are not properly fitted, can be dangerous. Please read these instructions carefully prior to fitting and comply with the instructions at all times. If in a doubt please contact us e: sales@aussietonneaus.com.au

⚠ Read all instructions prior to fitting the cover. ⚠

1. Attach the rope track (Front wall of ute bed at same height)

- Before starting the installation process, clean all the top surfaces of the tub.

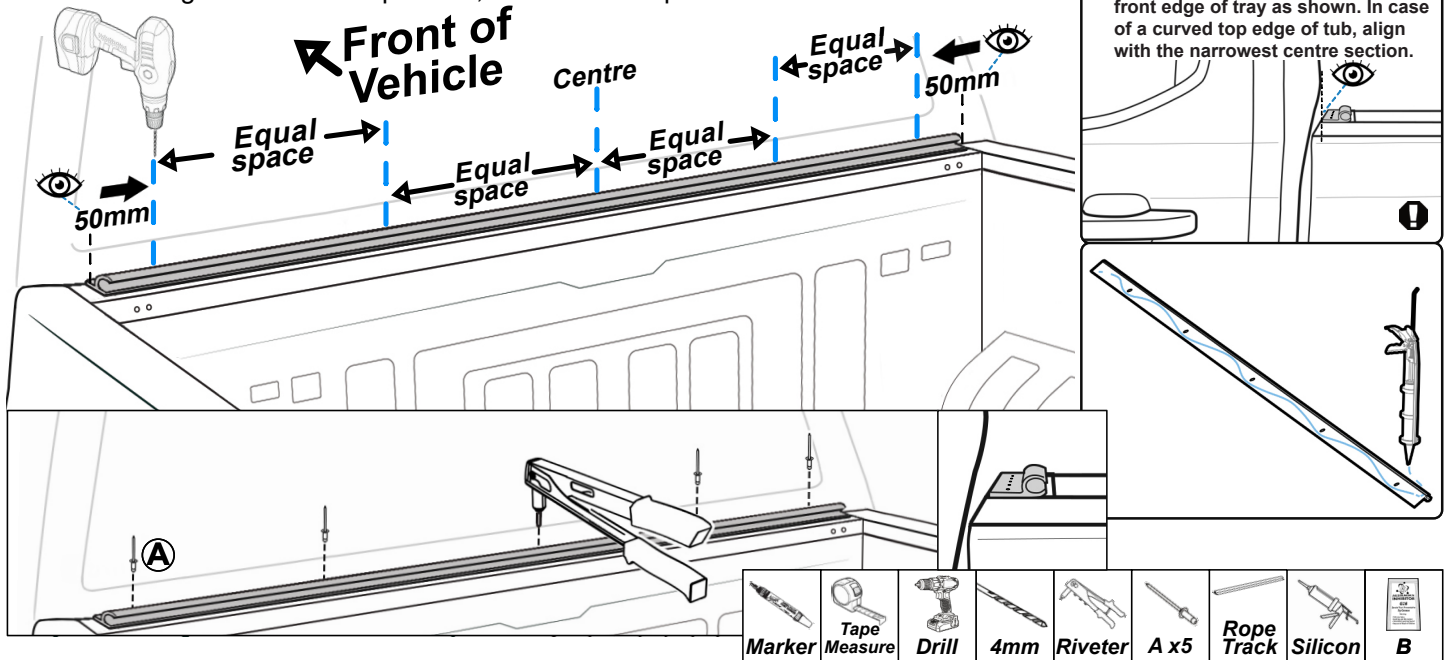

> Measure and centre align the rope track and place the track flush to the top front edge of the tub as shown above.

> Measure, mark and drill the two end holes 50mm from both ends of the rope track with a 4mm drill bit. Mark and drill 3 more holes with 4mm drill bit, with equal spacing between them. Apply rust inhibitor (B) into drilled holes.

> Then apply silicone behind the rope track, before riveting the rope track into place with the rivets (A) and a riveter.

1.1 Rope track attachment (Front wall of ute bed with a drop)

> Some ute models will have a tub design where the front wall of the ute bed is lower than the side walls. For such models, a different rope track is provided in the kit. Follow the orientation below for models with a lower front wall -

- Before starting the installation process, clean all the top surfaces of the tub.

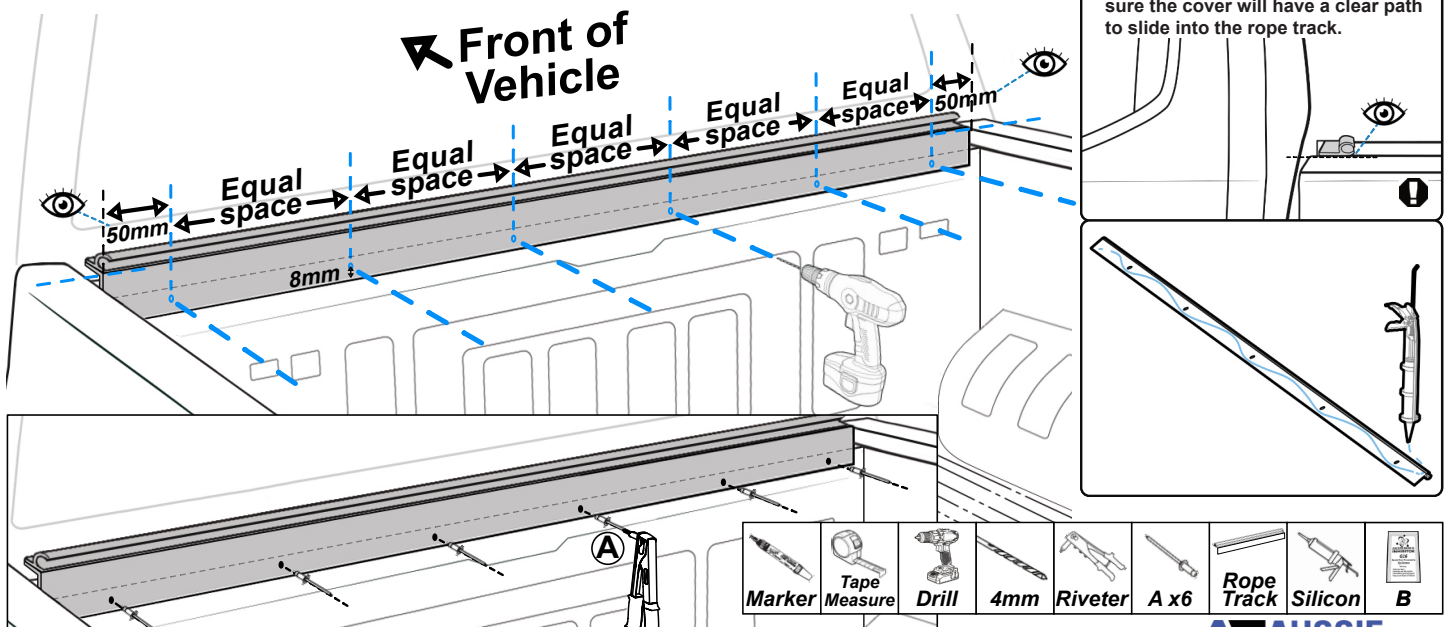

> Ensure the rope track is aligned at same height as the side walls of tub. Centre align the rope track and place the track flush against the front wall of the tub as shown.

> Measure, mark and drill the two end holes 50mm from both ends of the rope track with a 4mm drill bit. Mark and drill 4 more holes with 4mm drill bit, with equal spacing between them and 8mm from bottom edge. Apply rust inhibitor **(B)** into drilled holes.

> Then apply silicone behind the rope track, before riveting the rope track into place with the rivets **(A)** and a riveter.

2. Slide front end of cover into rope track

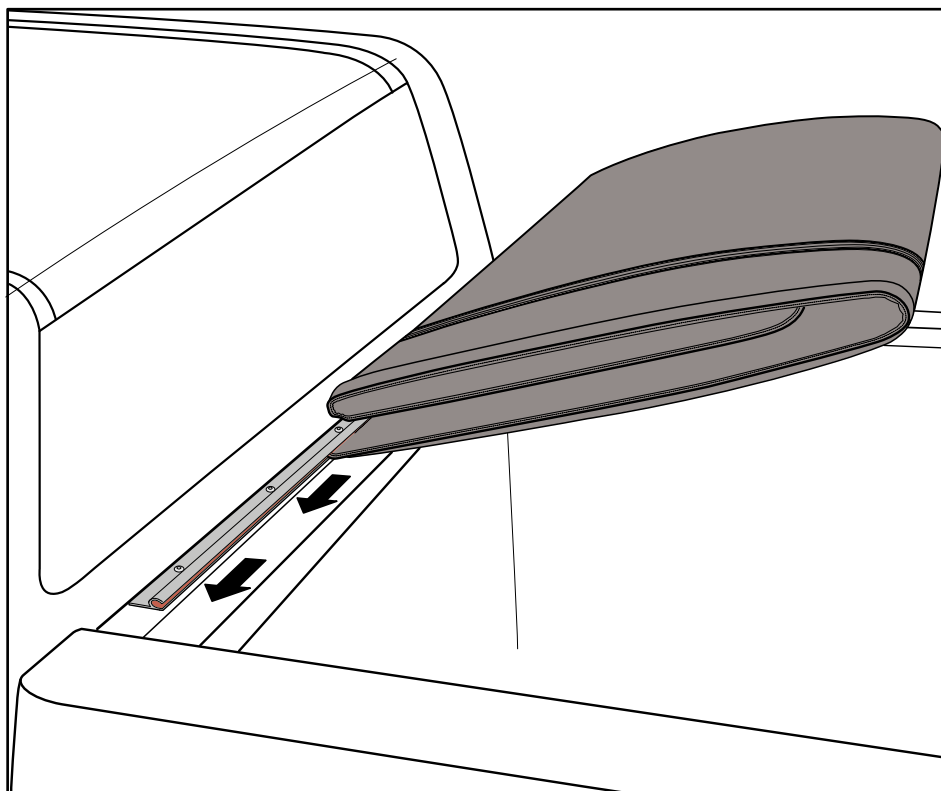

> Slide the Ezy Fold cover through the rope track from one end of rope track.

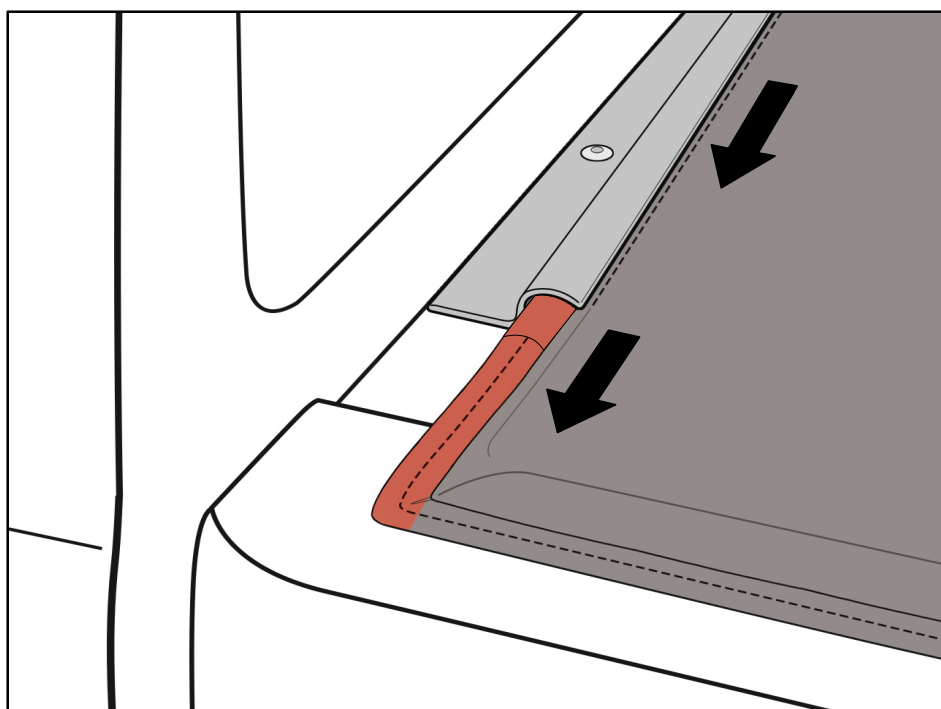

3. Tub attachment options

One of the 3 options or a combination can be used to attach the Ezy Fold cover to the vehicle tub, depending on tub factory design. In order of recommendation -

METHOD 1 - Using lock brackets (most recommended - requires drilling tub).

METHOD 2 - Using existing tub hooks (if tub has them from factory).

METHOD 3 - Using existing factory bolting points (if tub has them from factory).

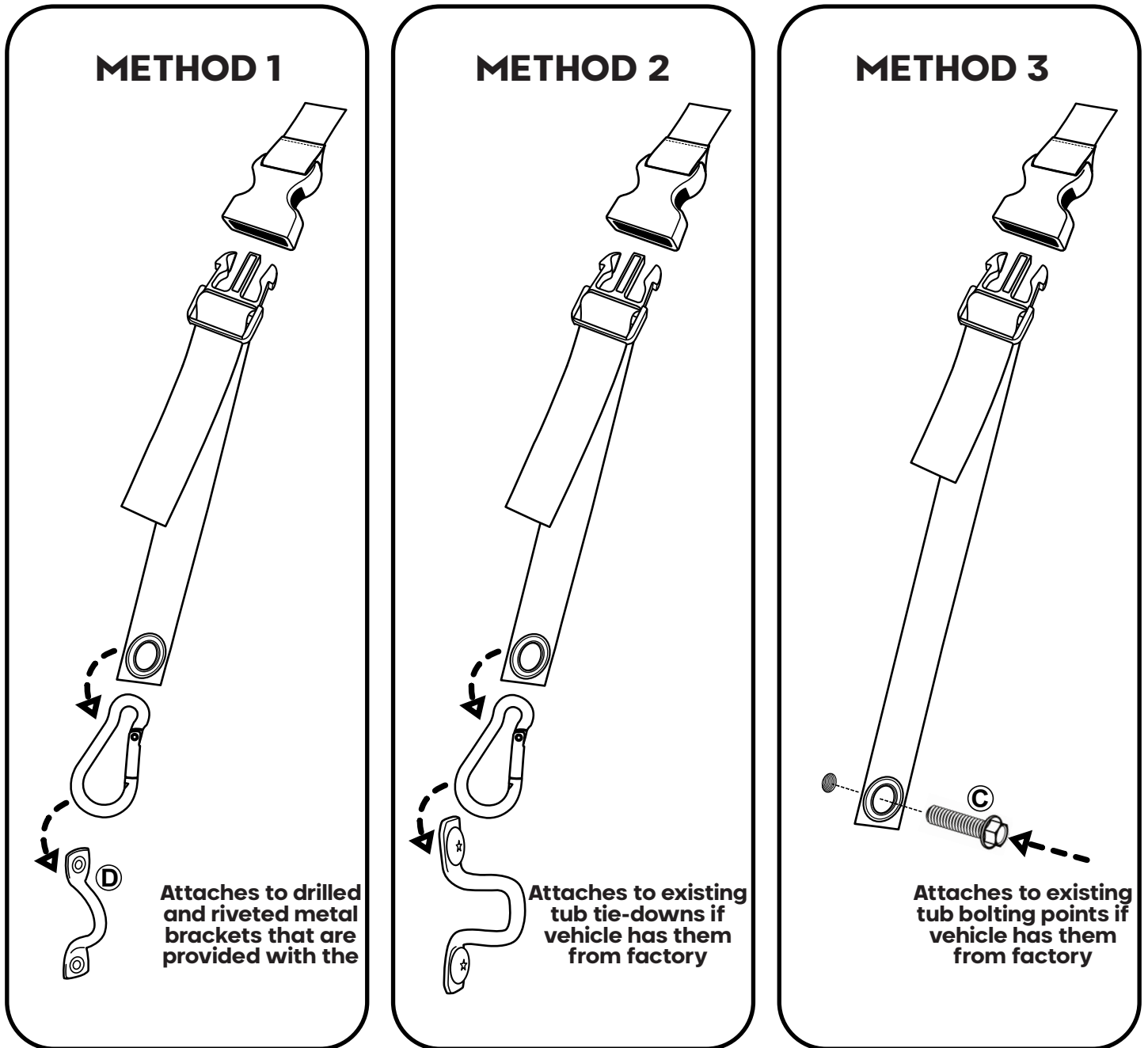

Pick the method you prefer based on your vehicle attachment features from factory. However, **Method 1** will offer the best fitment for the Ezy Fold cover and will provide least amount of movement when attached.

Method 1 Attachment to tub -

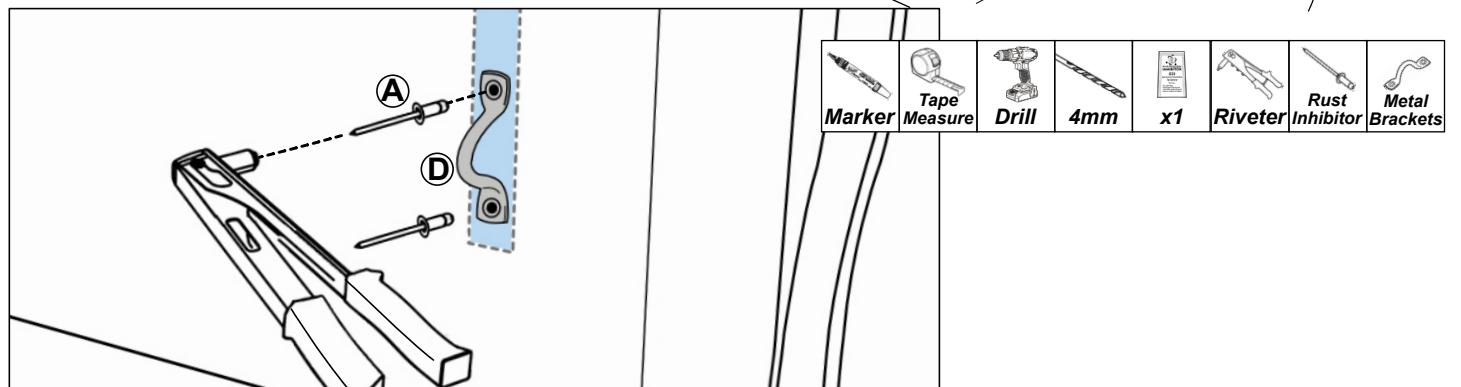
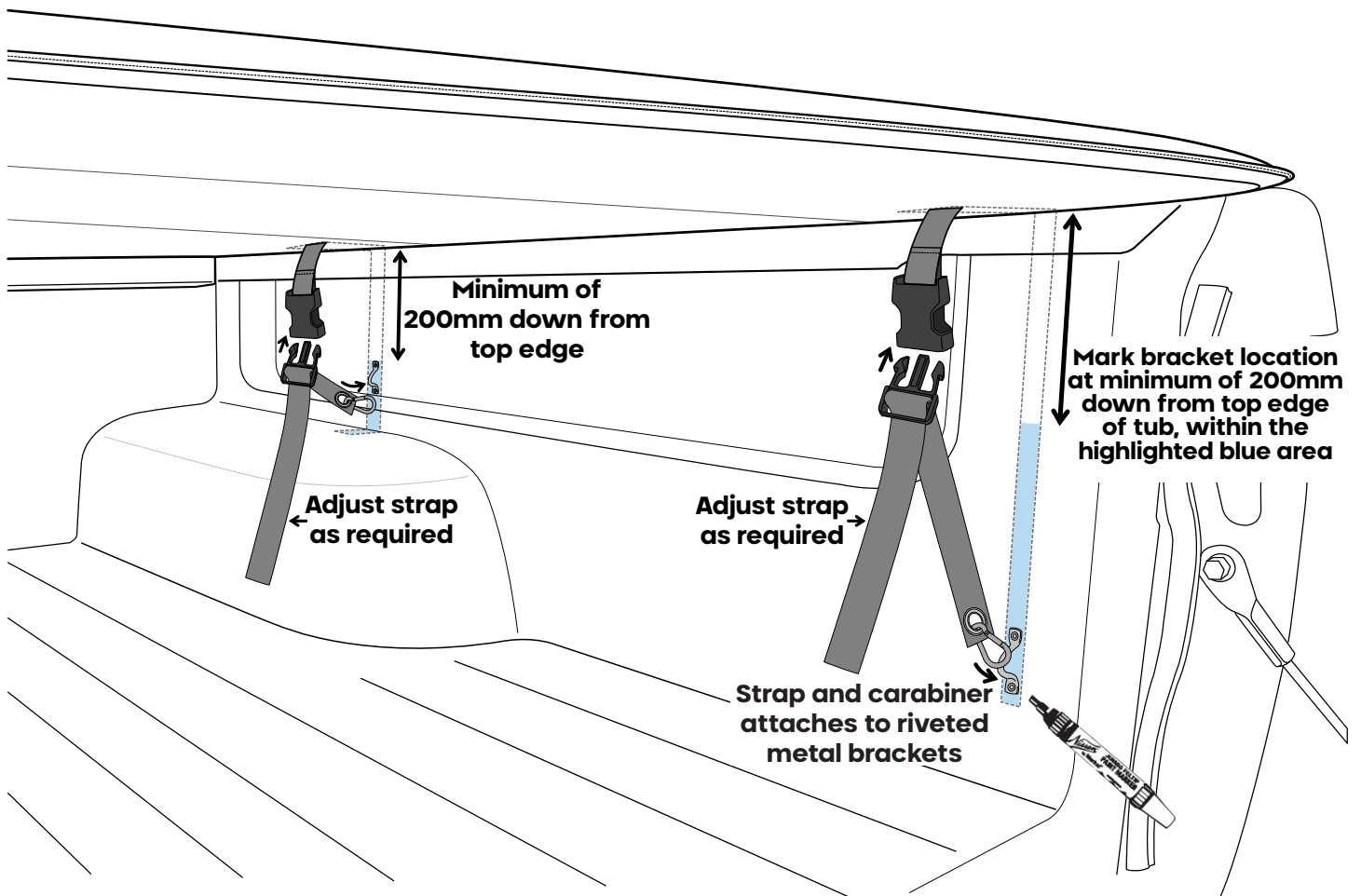

> Measure and mark the metal bracket **(D)** location to be drilled and riveted at a minimum of 200mm down from top edge of the tub. Keep the bracket location on the tub **in alignment with the buckles on the Ezy Fold cover**.

> Drill marked holes with a 4mm drill bit. Apply rust inhibitor **(B)** into drilled holes. Then rivet the metal bracket on to the tub with the rivets **(A)** and a riveter.

> Attach the carabiner with strap to the metal bracket. Attach the buckles.

> Repeat for opposite side of the tub.

> Once everything is in place and attached, adjust tension of the straps as required on all four corners for a secure fit of the Ezy Fold cover to the tub.

Method 2 Attachment to tub -

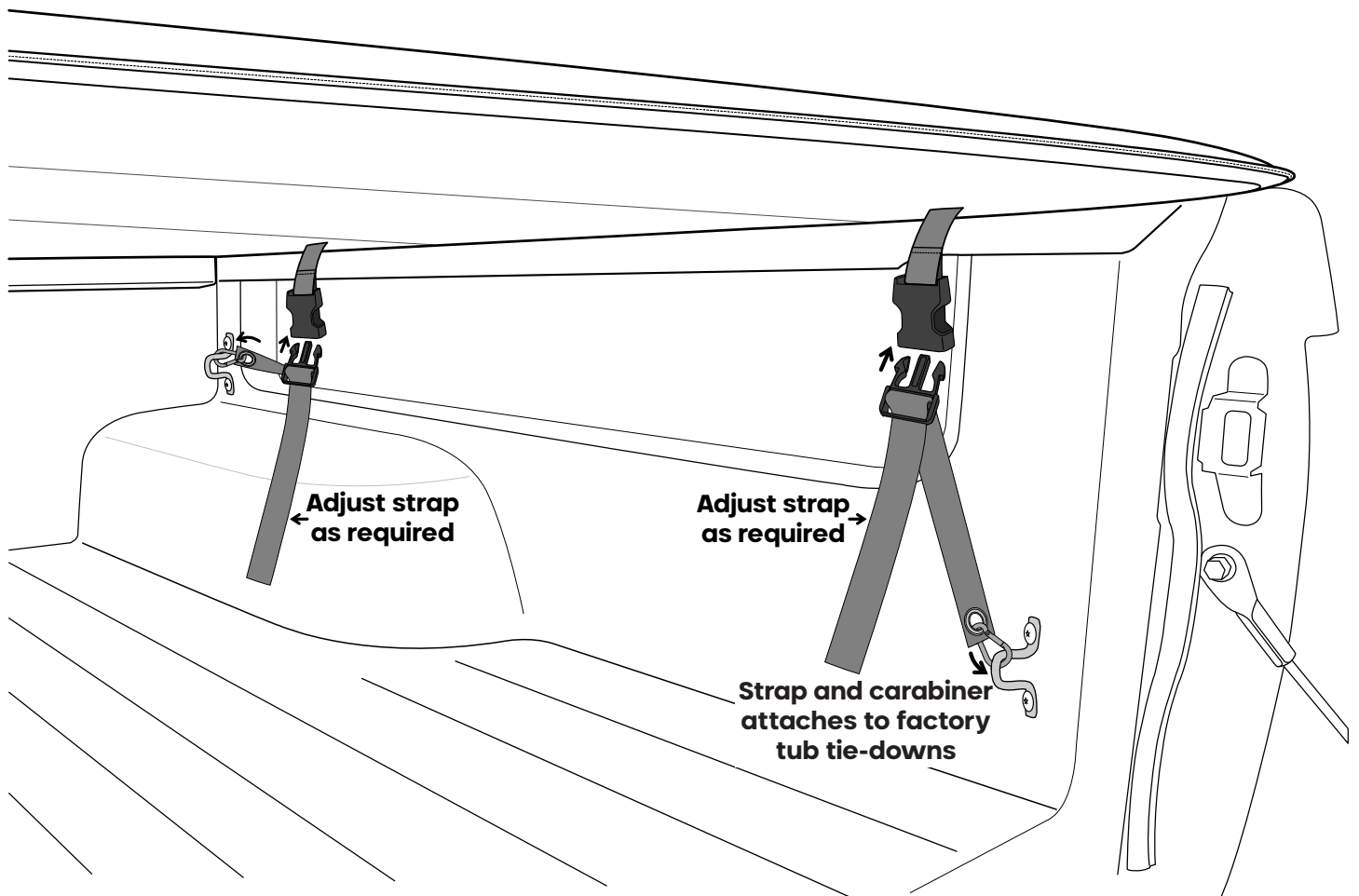

- > Locate factory mounted tie-downs in tub and attach the carabiner with strap to them as shown above. Attach the buckles.
- > Repeat for opposite side of the tub.
- > Once everything is in place and attached, adjust tension of the straps as required, on all four corners for a secure fit of the Ezy Fold cover to the tub.

Method 3 Attachment to tub -

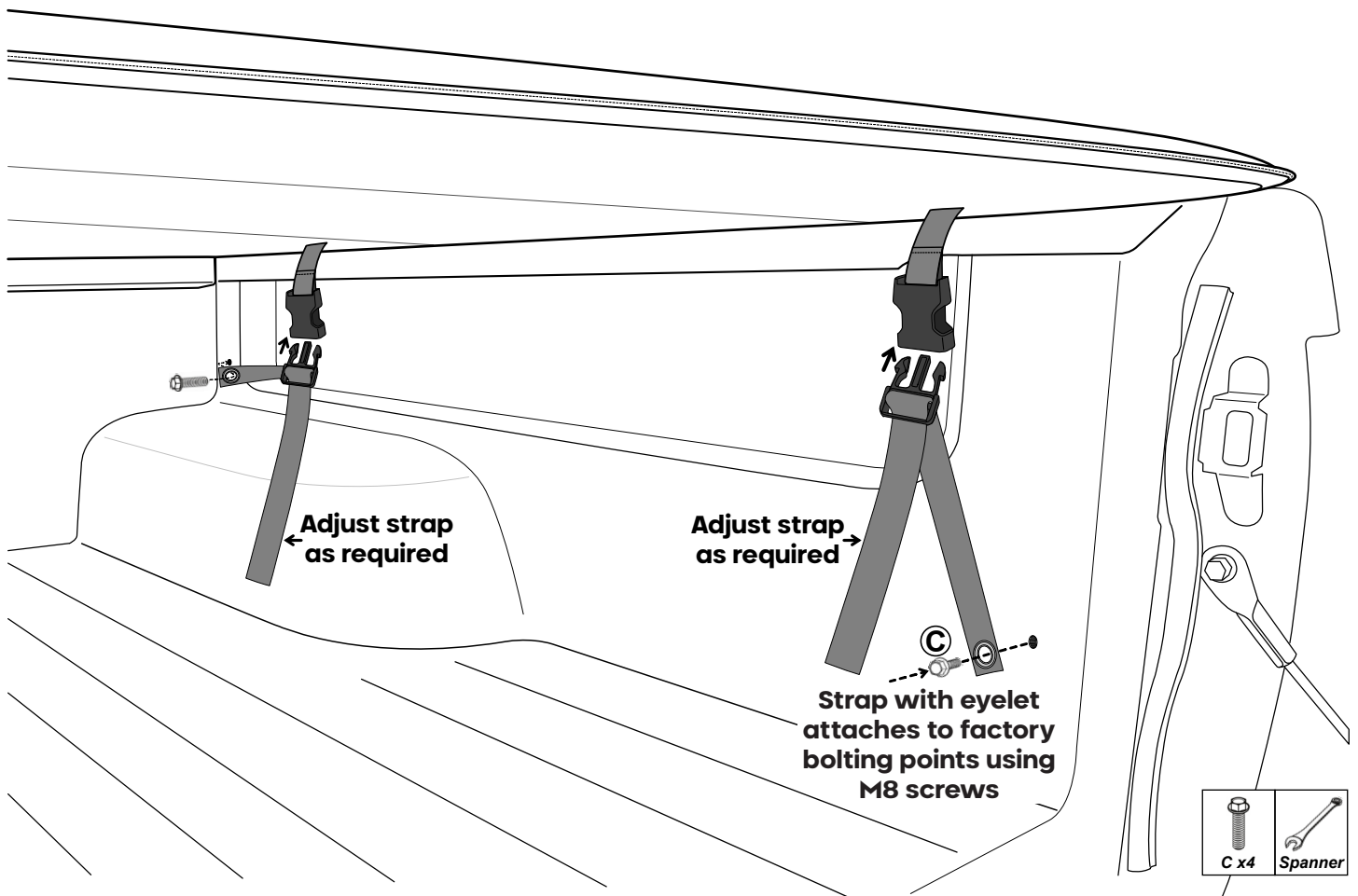

> Locate factory mounted bolting points in tub and attach the strap with the M8 screws © provided. The screw goes through the strap's eyelet and into the bolting points. Tighten screws with 13mm spanner. Attach the buckles.

> Repeat for opposite side of the tub.

> Once everything is in place and attached, adjust tension of the straps as required, on all four corners for a secure fit of the Ezy Fold cover to the tub.

Your installation is complete!

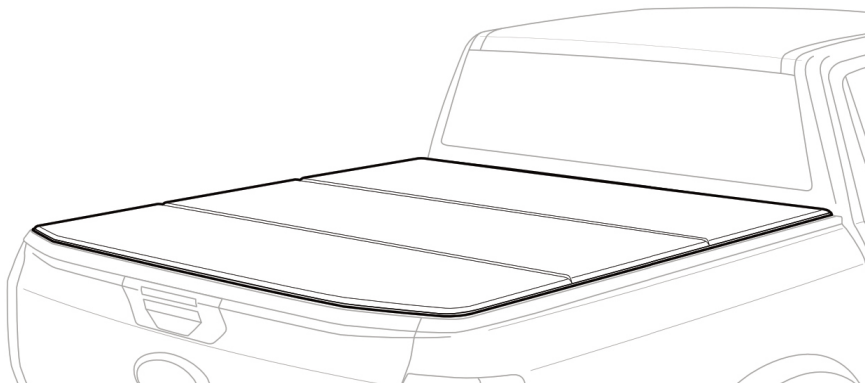

**Happy with how your Aussie Tonneaus Ezy Fold cover turned out?
Please send us a photo to: sales@aussietonneaus.com.au**